

Φ4mm 635nm Laser Module

Features

1. APC (auto power control) IC inside
2. Low current consumption of the APC circuit
3. Surge current protection
4. High quality DOE lens for special pattern

Part No. Indications:

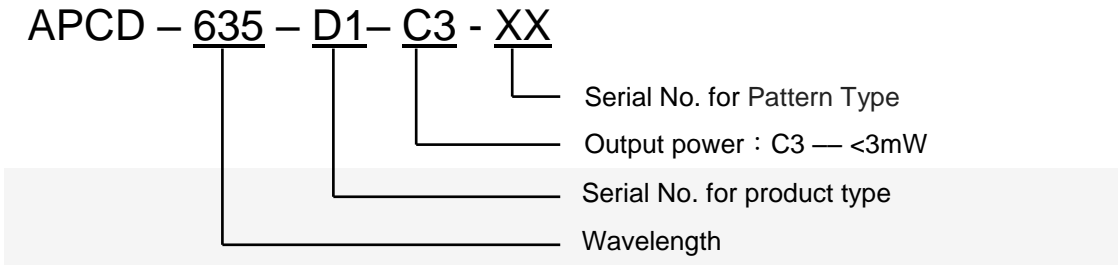

Absolute maximum ratings

Item	Symbol	Rating	Unit
Power supply voltage	V _{cc}	3.3	V
Laser Module optical output power	P _o	<3.5	mW
Operation temperature	T _{opr}	0~40	°C
Storage temperature	T _{stg}	-20~75	°C

Electrical and optical characteristics (T_c=25 °C)

Item	Symbol	Min.	Typ.	Max	Unit	Condition
Wavelength	λ	630	635	640	nm	P _o <3mW
Output power	P _{out}	-	-	3	mW	V _{cc} =3V
Operation current	I _{op}	-	-	45	mA	P _o =3mW V _{cc} =3V
Operation voltage	V _{op}	2.5	-	3.3	Volt	

Outline dimensions (Units: mm)

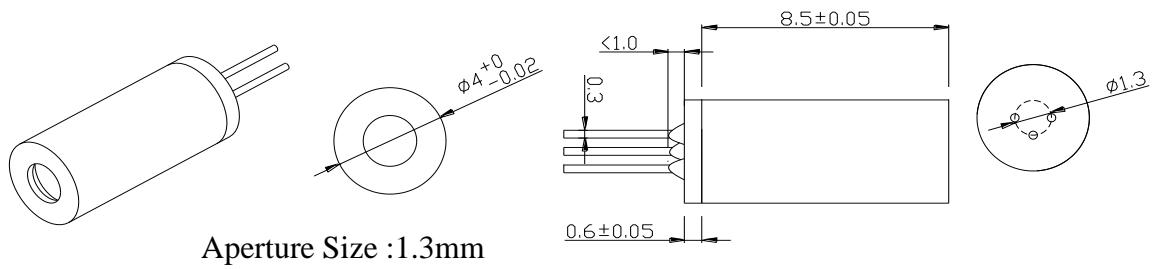

Red wire : Vcc

Black wire : GND

Pattern Type

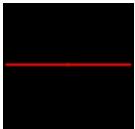
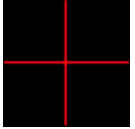
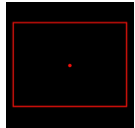
Arima P/N	APCD-635-D1-C3-01		APCD-635-D1-C3-02	
Pattern type	Line - 65°		Crosshair - 45°	
Arima P/N	APCD-635-D1-C3-03			
Pattern type	Line Square			

Laser Safety Precautions

1. Do not look into the laser beam directly by eyes. The laser beam may cause severe damage to human eyes.
2. Optical Lens is made of plastic or glass . Do not contaminate lens by soiling, oil or chemical.