

# Visible Laser Diode Module

**AML-D450-RGB050-01**

## RGB Laser Module

### Features

1. APC (auto power control) driver circuit
2. Output powers up to 50 mW
3. High quality glass lens for output beam
4. easy integration
5. low maintenance

### Applications

1. Highly Efficient RGB Laser Light Source
2. laser projector
3. laser light shows

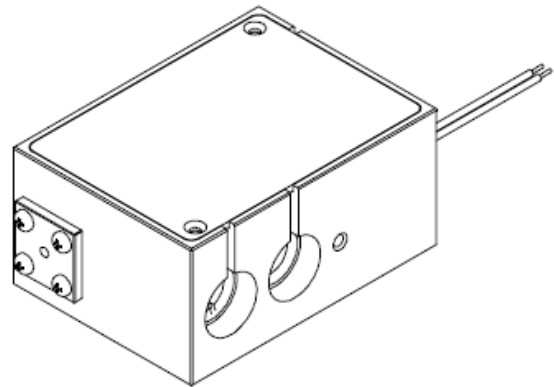

### Part No. Indications:

AML- D 450 - RGB 050 - 01

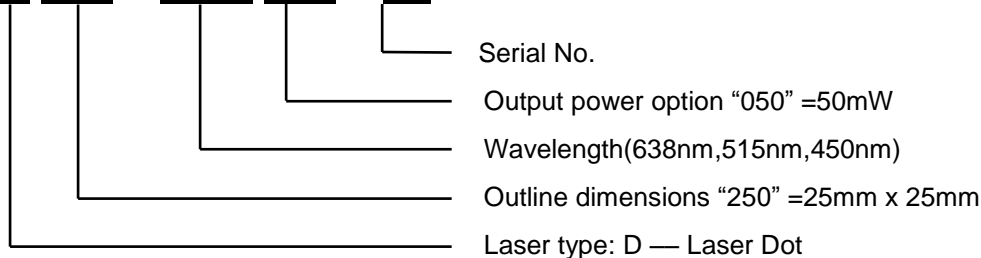

### Absolute maximum ratings ( $T_c=25^\circ\text{C}$ )

Item	Symbol	Rating	Unit
Power supply voltage	$V_{cc}$	9	V
Laser Module optical output power	$P_o$	50	mW
Operation Case Temperature	$T_c$	0~30	$^\circ\text{C}$
Storage Temperature	$T_{stg}$	-40~80	$^\circ\text{C}$

### Electrical and optical characteristics ( $T_c=25^\circ\text{C}$ )

Item	Symbol	Red	Green	Blue	Unit	Condition
Wavelength	$\lambda$	638	520	450	nm	
Output power	$P_{out}$	20	9	14	mW	$V_{cc}=9V$
Operation current	$I_{op}$	100	150	120		
Laser Beam spot size at 10m					<20mm	
Divergence angle					2 mrad	

# Visible Laser Diode Module

**AML-D450-RGB050-01**

**Outline dimensions (Units: mm)**

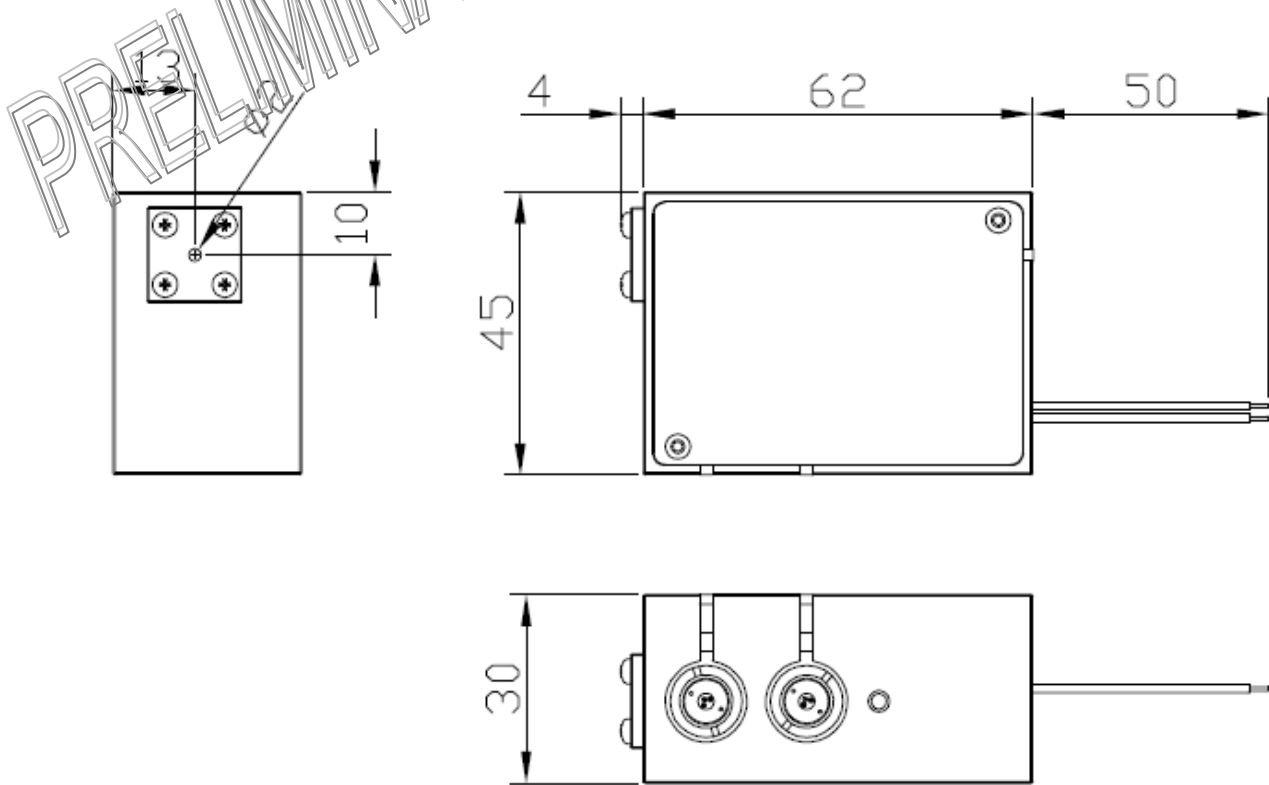

**Red wire : Vcc**

**Black wire : GND**

## Laser Safety Precautions

1. Do not look into the laser beam directly by eyes. The laser beam may cause severe damage to human eyes.
2. Optical Lens is made of glass . Do not contaminate lens by soiling, oil or chemical.